



ישיבה גדולה
Yeshiva Gedolah of
Elkins Park ד'עלקינס פארק

Building a Yeshiva • Building Talmidim



Creating a lifelong Kesher to Torah



Dear Friend, עמורט

Twelve years ago הקב"ה granted me the opportunity to teach תלמידים, helping to mold the next דור of klal Yisroel. I was given the responsibility of forming and implementing the vision of a vibrant and thriving ישיבה.

The Kehilla of Washington Heights gracefully embraced this vision and helped me cultivate and actualize this opportunity.

The ישיבה began with eight בחורים, then quickly grew to almost 100 בחורים. Eventually the תלמידים were housed in fifteen apartments in five different buildings in the neighborhood, and I now feel compelled to find a place spacious enough for this מקום תורה.

I hope to build a beautiful home that will enable all the תלמידים to live and learn comfortably, with הרהבת הדעת.

My goal is to create a comprehensive building that will also accommodate former תלמידים that wish to live near the ישיבה. This will be an ideal place for alumni to move with their families, so that they can remain linked to their ישיבה and have their lives enriched by its התורה.

This brochure will give you a detailed view of the campus and our vision for the yeshiva's future. בסייעתא דשמיא.

Thank you for your interest in this monumental project.

Yehoshua Chaim Rubanowitz
ROSH YESHIVAH





אודם פ' מאז בני ובתק רבים אהלנו

With much הודאה to הקב"ה, the ישיבה was able to acquire a picturesque 7.5 acre property with 40,000 square feet of indoor space in Elkins Park, Pennsylvania. This secluded northeast Philadelphia suburb is an oasis of serenity and מנוחת הנפש.



בורא עולם בקנין השלם זה הבנין



אפקדו מורה ואלאדורה

Plans have been drawn up for a bais medrash and a shiur room, with an attached dormitory that includes a dining room and an industrial kitchen. A move to Elkins Park, PA, presents an historic opportunity for the growth and expansion of the Yeshiva.



Bais Medrash





Architect Plans

The Rosh HaYeshiva has reserved the Shiur Room to be dedicated by the Talmidim.

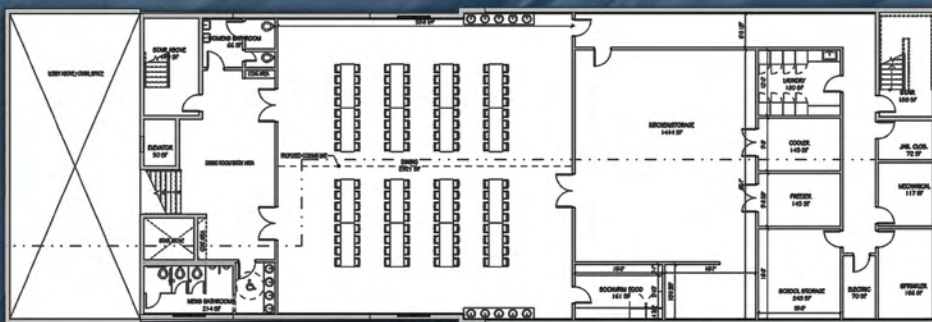
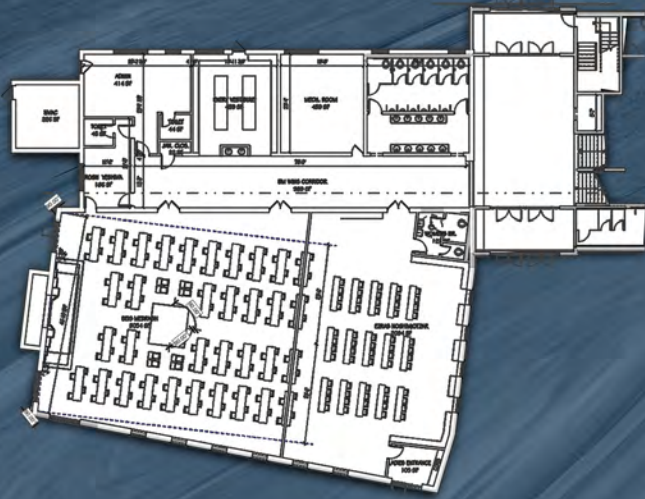

Dormitory



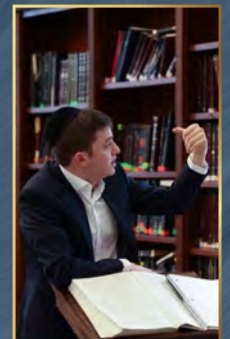



Dedication Opportunities

Founder

CAMPUS NAME	RESERVED	\$2,000,000
YESHIVA NAME		\$1,800,000
YESHIVA BUILDING	RESERVED	\$1,500,000
BAIS MEDRASH	RESERVED	\$1,000,000
DORMITORY BUILDING		\$1,000,000

Master Builder

SHIUR ROOM	RESERVED FOR TALMIDIM	\$750,000
FACULTY HOUSING		\$750,000
DINING ROOM	RESERVED	\$500,000

Builder

ARON KODESH	RESERVED	\$380,000
OTZAR HASEFORIM		\$360,000
EZRAS NASHIM	RESERVED	\$250,000
MAIN ENTRANCE SHAAR	RESERVED	\$250,000
MAIN HEICHEL/LOBBY	RESERVED	\$180,000
BAIS MEDRASH SHAAR		\$180,000
BAIS MEDRASH LIGHTING	RESERVED	\$180,000
KITCHEN	RESERVED	\$150,000
ROSH HAYESHIVA OFFICE	RESERVED	\$150,000
BAIS MEDRASH SEFORIM	RESERVED	\$100,000
REBBE'S ROOM		\$100,000

Visionary

EZRAS NASHIM FURNISHING		\$75,000
NER TAMID	RESERVED	\$75,000
PAROCHES	RESERVED	\$50,000
YOMIM NORIEM PAROCHES	RESERVED	\$50,000
BIMAH	RESERVED	\$50,000
AMUD	RESERVED	\$50,000
MAIN OFFICE		\$50,000

Pillar

MAIN ENTRANCE MEZUA	\$36,000
BAIS MEDRASH MEZUA (2)	\$36,000
DORMITORY ROOMS (25)	\$25,000
LANDSCAPING	\$25,000
COAT ROOM	\$18,000
COFFEE ROOM	\$18,000

Partner

BAIS MEDRASH SEFORIM SHRANK (10)	\$10,000
BAIS MEDRASH TABLES (20)	\$5,000
BAIS MEDRASH WINDOWS (10)	1 RESERVED \$5,000
OTZAR SEFORIM SHRANKS(15)	\$3,600
MEZUA (35)	4 RESERVED \$1,800

The yeshiva's vision is to include a Kollel in Elkins Park; an opportunity for former talmidim to live close to the yeshiva. DEDICATIONS ARE AVAILABLE FOR NAMING OF THE KOLLEL HOUSING.



8201 HIGH SCHOOL ROAD ♦ ELKINS PARK, PA 19027

PHONE 212.419.5758 | EMAIL SSTEINBERG@YGEP.ORG | ONLINE WWW.YGEP.ORG